

Legend

Order Limits

Date: 19/04/21
 Created by: MS
 Checked by: TD
 Doc no: 10872-0136-27
 Scale: A1@ 1:10,000
 Reference System: OSGB36
 Projection: BNG

N
 0 100 200 300 400 500 600 700 800 900 1,000 Metres

Rev	Date	Remark
1	23/07/20	S51 response: addition of sheet 6
2	30/10/20	Habitat creation changes
3	03/02/21	Work 10 order limits changes
4	19/04/21	Access change

APFP Regulations Reference: 5(2)(j)
 Application Document Number: A2.3

Thurrock Flexible Generation Plant Work Plans Index Sheet



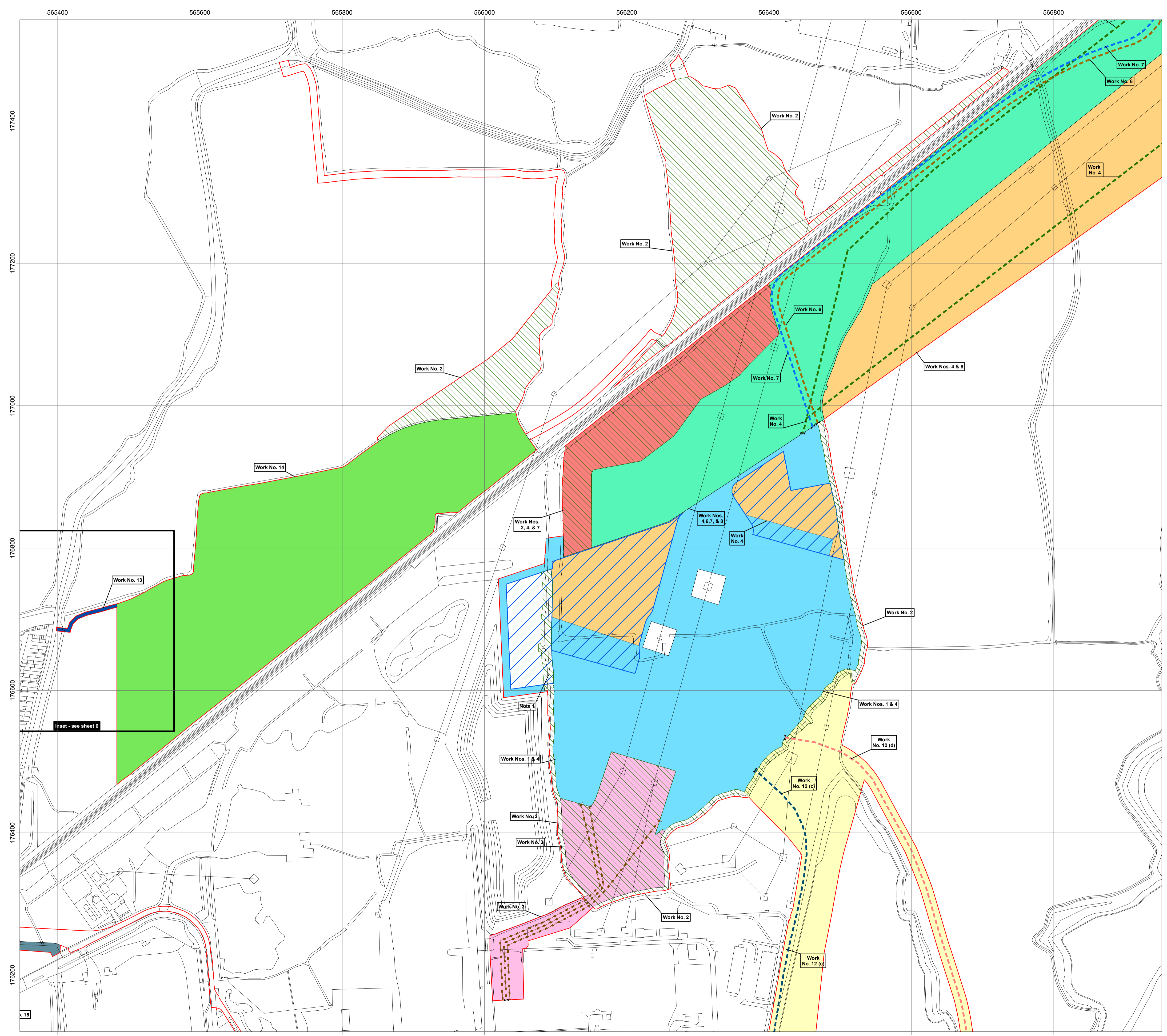

- ### Legend
- Order Limits
 - Work No. 3A indicative centreline
 - Work No. 4 indicative centreline
 - Work No. 6 indicative centreline
 - Work No. 7 indicative centreline
 - Work No. 12 (c) indicative centreline
 - Work No. 12 (d) indicative centreline
 - Work No. 15 indicative centreline
 - Start of linear work
 - End of linear work
 - Work No. 1 and Work No. 4 limit of deviation
 - Work No. 2
 - Work No. 3 limit of deviation
 - Work No. 4 limit of deviation, Work No. 6 limit of deviation, Work No. 7 limit of deviation and Work No. 8
 - Work No. 4 limit of deviation and Work No. 7 limit of deviation
 - Work No. 4 limit of deviation and Work No. 8
 - Work No. 12 limit of deviation
 - Work No. 13
 - Work No. 14
 - Work No. 15
 - Land for carbon capture readiness (CCR)

Note 1: Ditch to be retained unless CCR land is developed.

Date: 19/04/21
 Created by: MS
 Checked by: TD
 Doc no: 10872-0136-27
 Scale: A1@ 1:2,500
 Reference System: OSGB36
 Projection: BNG



Rev	Date	Remark
1	23/07/20	S51 response: addition of sheet 6
2	30/10/20	Habitat creation changes
3	03/02/21	Work 10 order limits changes
4	19/04/21	Access change

APFP Regulations Reference: 5(2)(j)
 Application Document Number: A2.3

**Thurrock Flexible Generation Plant
 Work Plans
 Sheet 2 of 6**



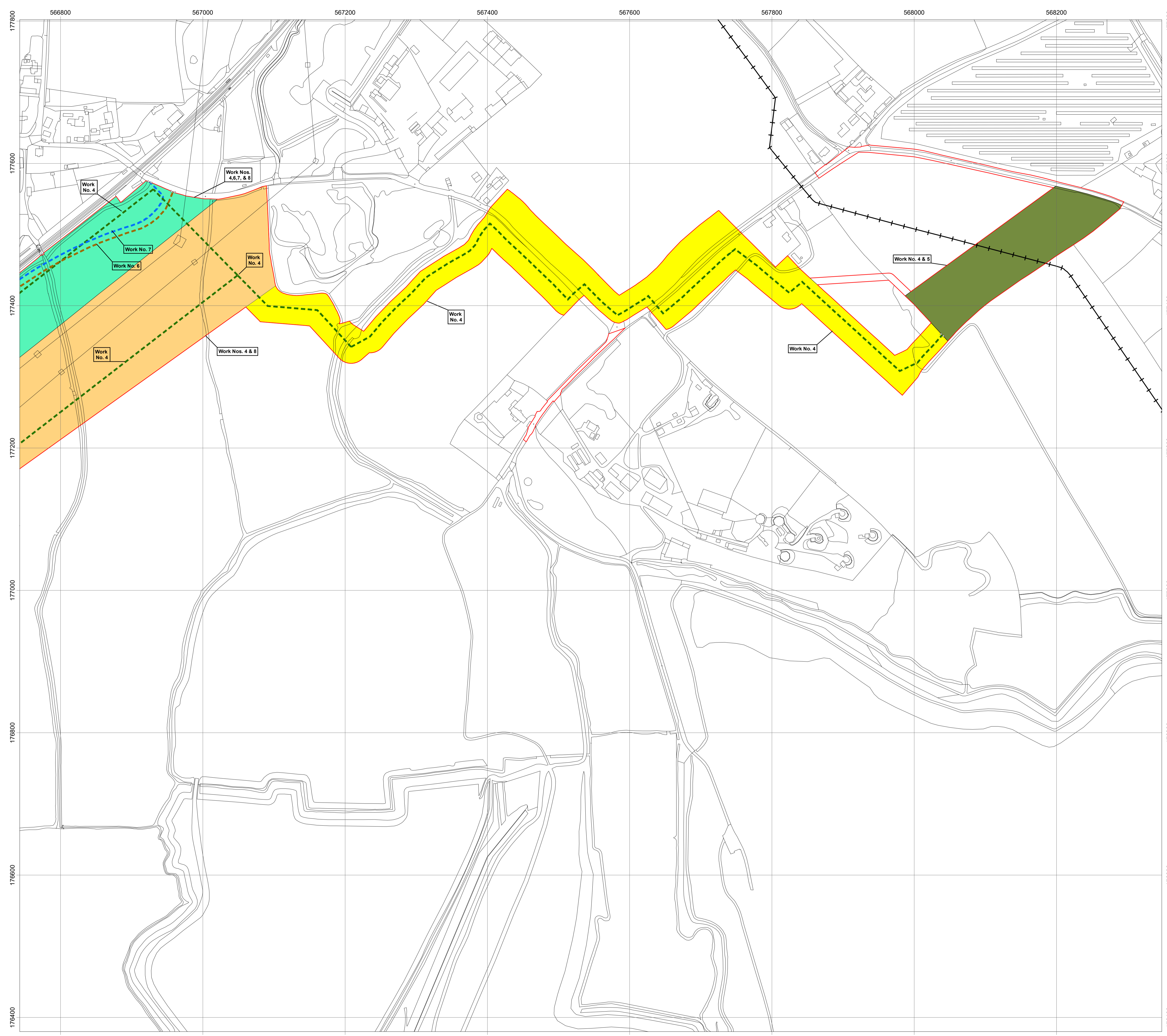

Legend

- Order Limits
- Work No. 4 indicative centreline
- Work No. 6 indicative centreline
- Work No. 7 indicative centreline
- Start of linear work
- National Grid gas pipeline Feeder 18
- Work No. 4
- Work No. 4 limit of deviation and Work No. 5
- Work No. 4 limit of deviation, Work No. 6 limit of deviation, Work No. 7 limit of deviation and Work No. 8
- Work No. 4 limit of deviation and Work No. 8

Date: 19/04/21
 Created by: MS
 Checked by: TD
 Doc no: 10872-0136-27
 Scale: A1@ 1:2,500
 Reference System: OSGB36
 Projection: BNG



Rev	Date	Remark
1	23/07/20	S51 response: addition of sheet 6
2	30/10/20	Habitat creation changes
3	03/02/21	Work 10 order limits changes
4	19/04/21	Access change

APFP Regulations Reference: 5(2)(j)
 Application Document Number: A2.3

Thurrock Flexible Generation Plant
 Work Plans
 Sheet 3 of 6



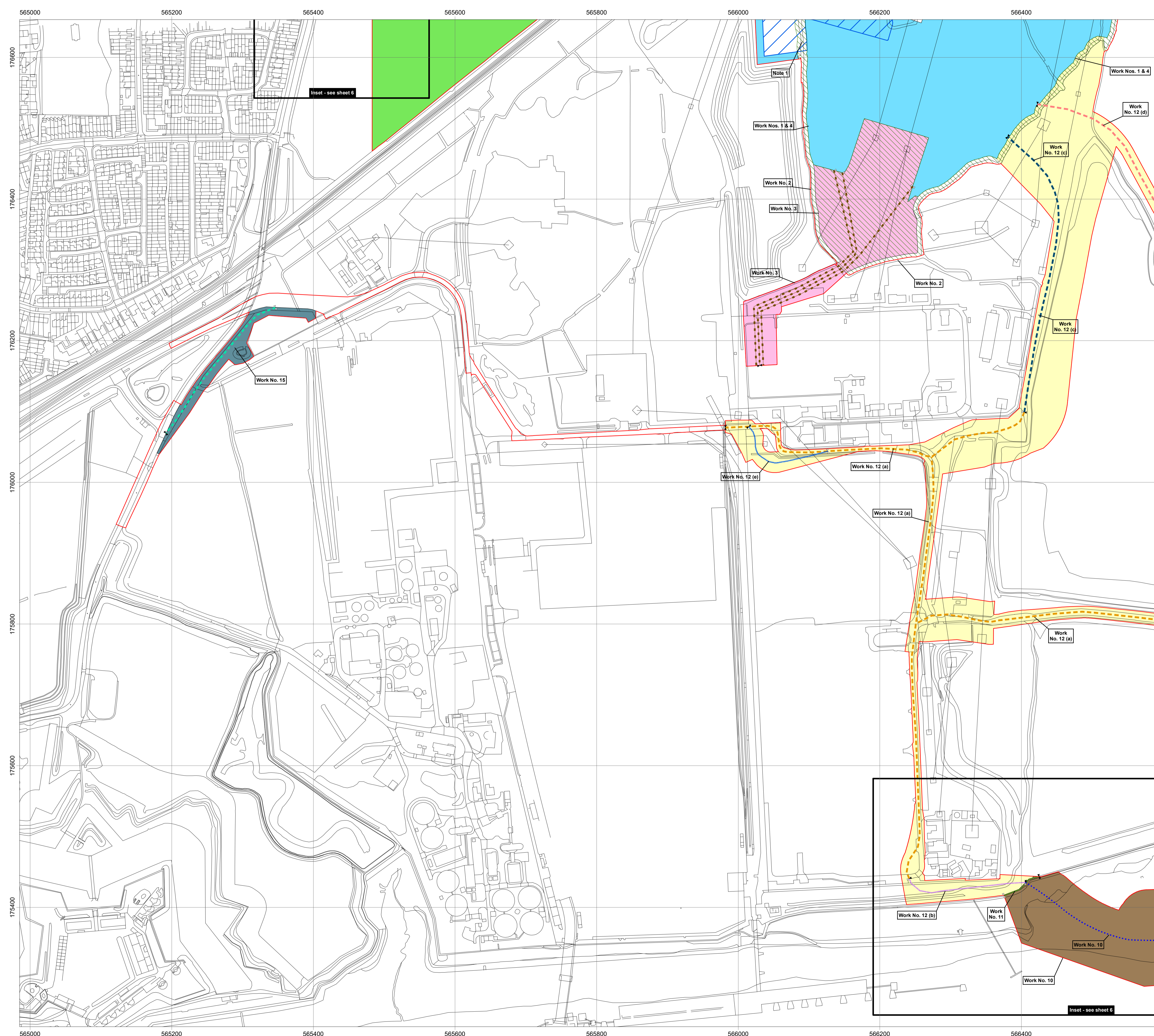

Legend

- Order Limits
- Work No. 3A indicative centreline
- Work No. 10 indicative centreline
- Work No. 12 (a) indicative centreline
- Work No. 12 (b) indicative centreline
- Work No. 12 (c) indicative centreline
- Work No. 12 (d) indicative centreline
- Work No. 12 (e) indicative centreline
- Work No. 15 indicative centreline
- Start of linear work
- End of linear work
- Co-terminus start of linear work and end of linear work
- Work No. 1 and Work No. 4 limit of deviation
- Work No. 2
- Work No. 3 limit of deviation
- Work No. 10 limit of deviation
- Work No. 12 limit of deviation
- Work No. 14
- Work No. 15
- Land for carbon capture readiness (CCR)

Note 1: Ditch to be retained unless CCR land is developed.

Date: 19/04/21
 Created by: MS
 Checked by: TD
 Doc no: 10872-0136-27
 Scale: A1@ 1:2,500
 Reference System: OSGB36
 Projection: BNG



Rev	Date	Remark
1	23/07/20	S51 response: addition of sheet 6
2	30/10/20	Habitat creation changes
3	03/02/21	Work 10 order limits changes
4	19/04/21	Access change

APFP Regulations Reference: 5(2)(j)
 Application Document Number: A2.3

Thurrock Flexible Generation Plant
 Work Plans
 Sheet 4 of 6





Legend

- Order Limits
- Work No. 3A indicative centreline
- Work No. 10 indicative centreline
- Work No. 11
- Work No. 12 (a) indicative centreline
- Work No. 12 (b) indicative centreline
- Work No. 12 (c) indicative centreline
- Work No. 12 (d) indicative centreline
- Work No. 12 (e) indicative centreline
- Start of linear work
- End of linear work
- Co-terminus start of linear work and end of linear work
- Work No. 1 and Work No. 4 limit of deviation
- Work No. 2
- Work No. 3 limit of deviation
- Work No. 10 limit of deviation
- Work No. 12 limit of deviation
- Land for carbon capture readiness (CCR)

Note 1: Ditch to be retained unless CCR land is developed.

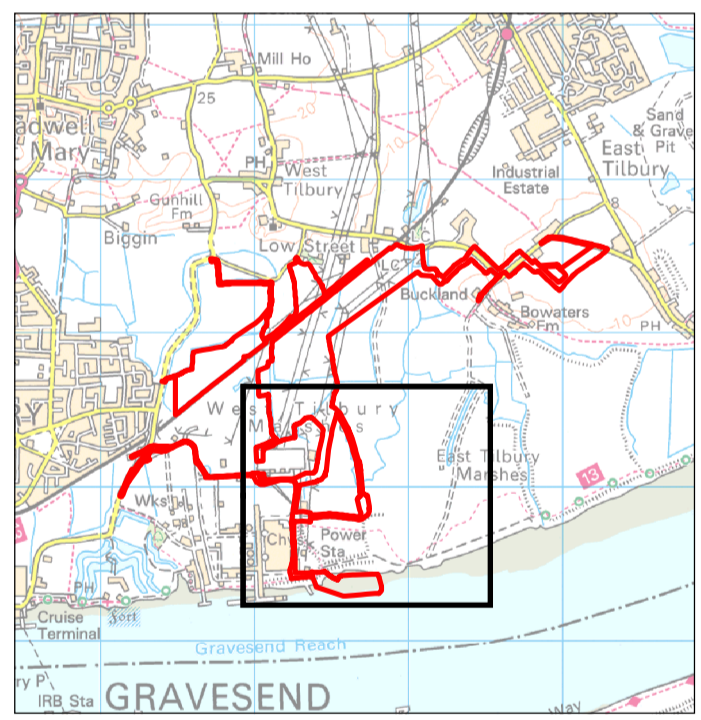

Date: 19/04/21
 Created by: MS
 Checked by: TD
 Doc no: 10872-0136-27
 Scale: A1@ 1:2,500
 Reference System: OSGB36
 Projection: BNG



Rev	Date	Remark
1	23/07/20	S51 response: addition of sheet 6
2	30/10/20	Habitat creation changes
3	03/02/21	Work 10 order limits changes
4	19/04/21	Access change

APFP Regulations Reference: 5(2)(j)
 Application Document Number: A2.3

Thurrock Flexible Generation Plant
 Work Plans
 Sheet 5 of 6



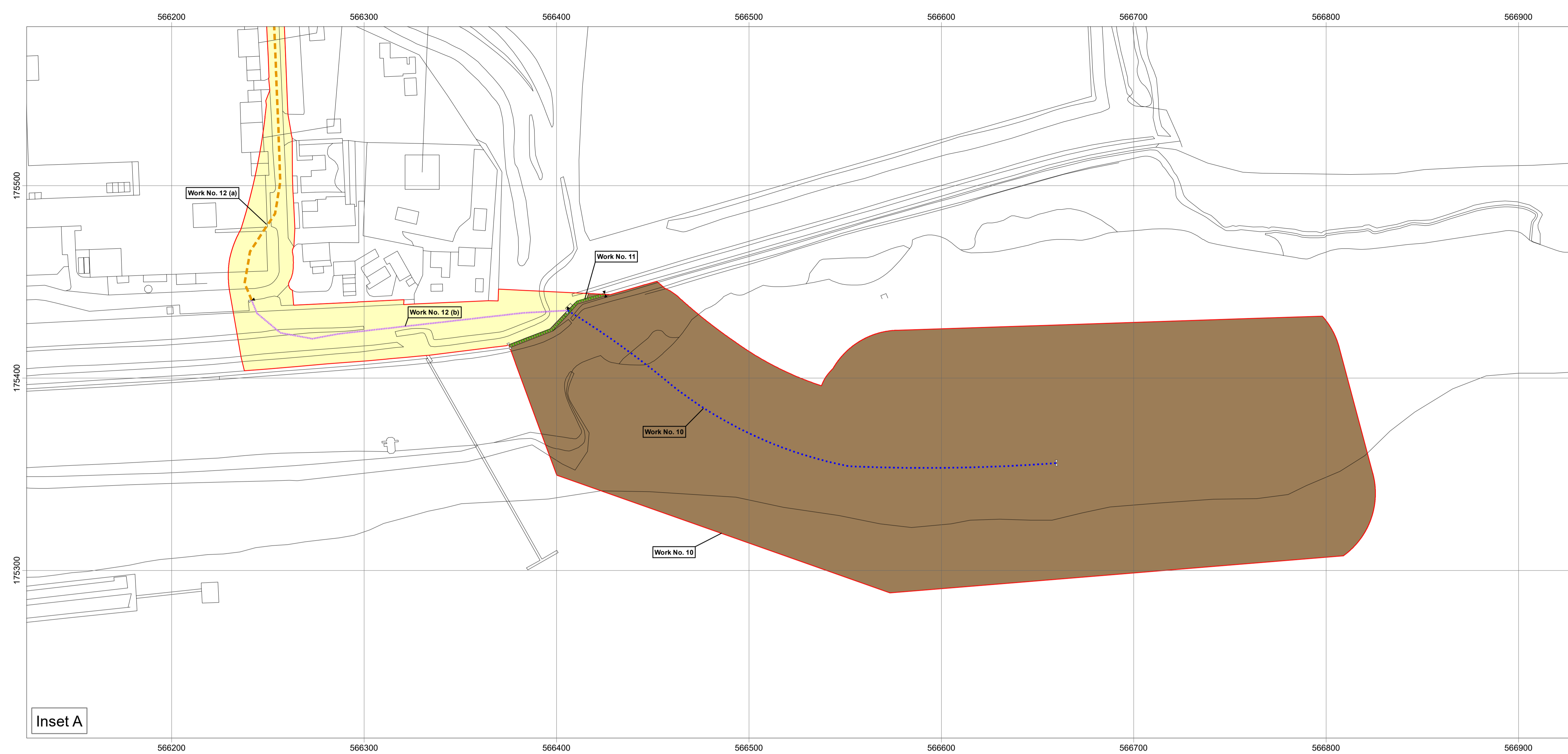

Legend

- Order Limits
- Work No. 10 indicative centreline
- Work No. 11
- Work No. 12 (a) indicative centreline
- Work No. 12 (b) indicative centreline
- Start of linear work
- End of linear work
- Co-terminus start of linear work and end of linear work
- Work No. 10 limit of deviation
- Work No. 12 limit of deviation
- Work No. 13
- Work No. 14

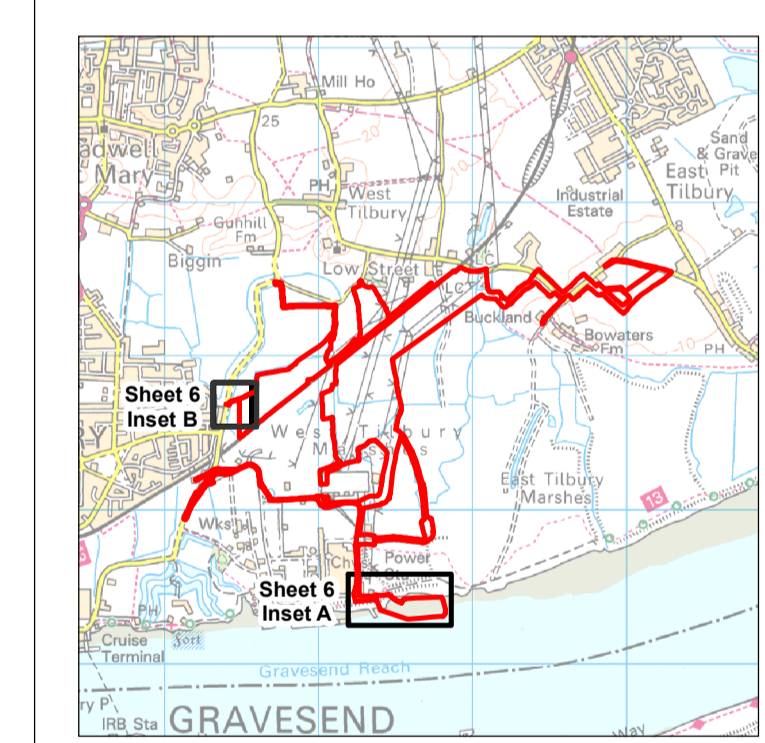

Date: 19/04/21
 Created by: MS
 Checked by: TD
 Doc no: 10872-0205-11
 Scale: A1@ 1:1,250
 Reference System: OSGB36
 Projection: BNG



Rev	Date	Remark
1	23/07/20	S51 response: addition of sheet 6
2	30/10/20	Habitat creation changes
3	08/02/21	Work 10 order limits changes
4	19/04/21	Access change

APFP Regulations Reference: 5(2)(j)
 Application Document Number: A2.3

Thurrock Flexible Generation Plant Work Plans Sheet 6 of 6

